

The logo for BTNGROUP features a blue square with a white starburst icon on the left, followed by the text "BTNGROUP" in a bold, black, sans-serif font.

PERGOLA VE CAM SİSTEMLERİ SANAYİ TİCARET LİMİTED ŞİRKETİ

The logo for PERGOLA TECHNOLOGY features a blue globe icon with a white starburst on the left, followed by the text "PERGOLA" in a bold, black, sans-serif font and "TECHNOLOGY" in a bold, blue, sans-serif font below it.

FINANCIAL OFFER

MANUAL SYSTEM

SLIDING GLASS SYSTEM

NAME:

DATE: **01-03-2024**

REFERENCE NAME: **ESTRES KING DAVID REFGLOSS SYSTEMS**

OPERATING MECHANISM

The sliding glass system is a manual system which slides to the right and left. It is also called "fan system" due to the fact that the glass sheets overlap when sliding, just like a fan.

FINANCIAL OFFER

SLIDING GLASS SYSTEM



This system is perfect for small terraces or balconies, because it offers protection against the wind and cold, and also creates a soundproof barrier and keeps away the urban noise.

The glass sheets are easy to slide and handle, being easy for the user to open the space whenever needed. You can have an open space in the summer and be protected from the cold in the winter.

The glass system is also perfect for creating a smoking zone in the cold seasons.

Designed in an elegant way, the system is also perfect for keeping the beautiful view, even when it's cold outside, rainy or windy. It keeps the heat or the chill inside, due to its insulation system. The extruded aluminium structure and tempered glass give the system great resistance and durability. The warranty for the system is 5 years.

**TECHNICAL
DETAILS**

- Double glazing, 20 mm thickness, clear glass.
- Extruded aluminium profiles.
- Electrostatic field painting, in any RAL of the palette.



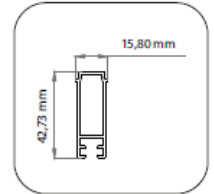
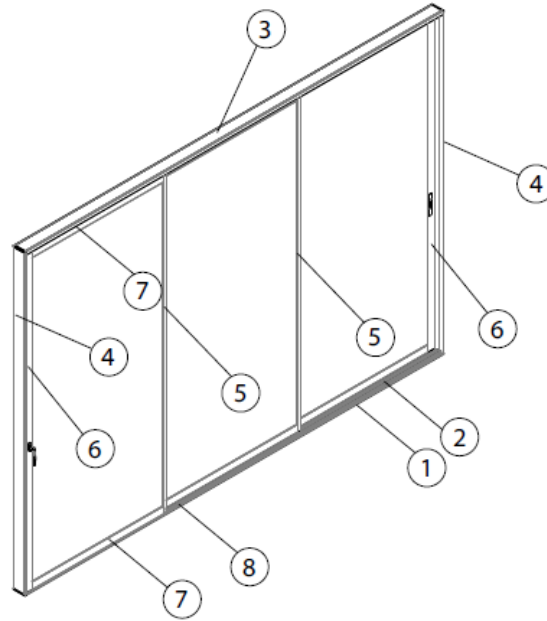

**Adaptor Profile
(Double Side System)**

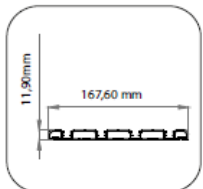

**1a- 4 Channel
Bottom Rail Profile**

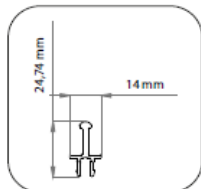

**2- Bottom Rail
Channel Profile**

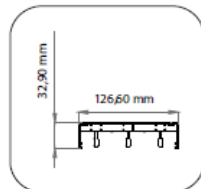

**3b- 2-3 Channel
Top Rail Profile**



**4b- 3 Channel
Side Rail Profile**

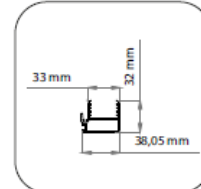

**5- Frame Vertical
Profile**

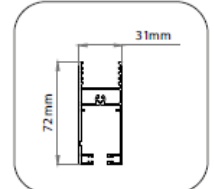

**7- Frame Top
Bottom Profile**

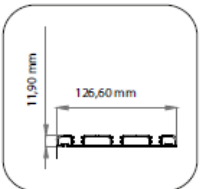

**1b- 2-3 Channel
Bottom Rail Profile**

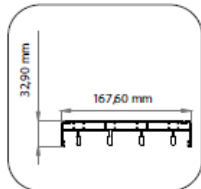

**3a- 4 Channel
Top Rail Profile**

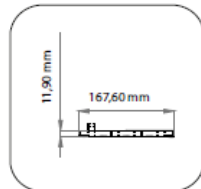

**4a- 4 Channel
Side Rail Profile**

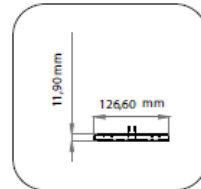

**4c- 2 Channel
Side Rail Profile**

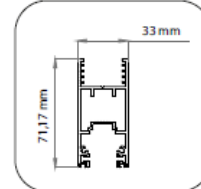

**6- Frame Vertical
End Profile**

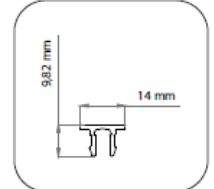

**8- Bottom Rail
Cover Profile**

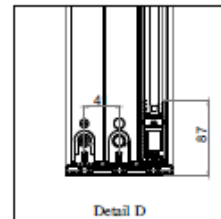
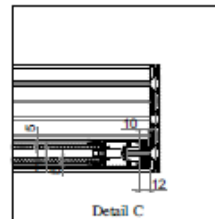
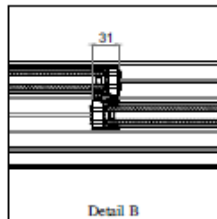
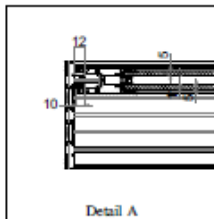
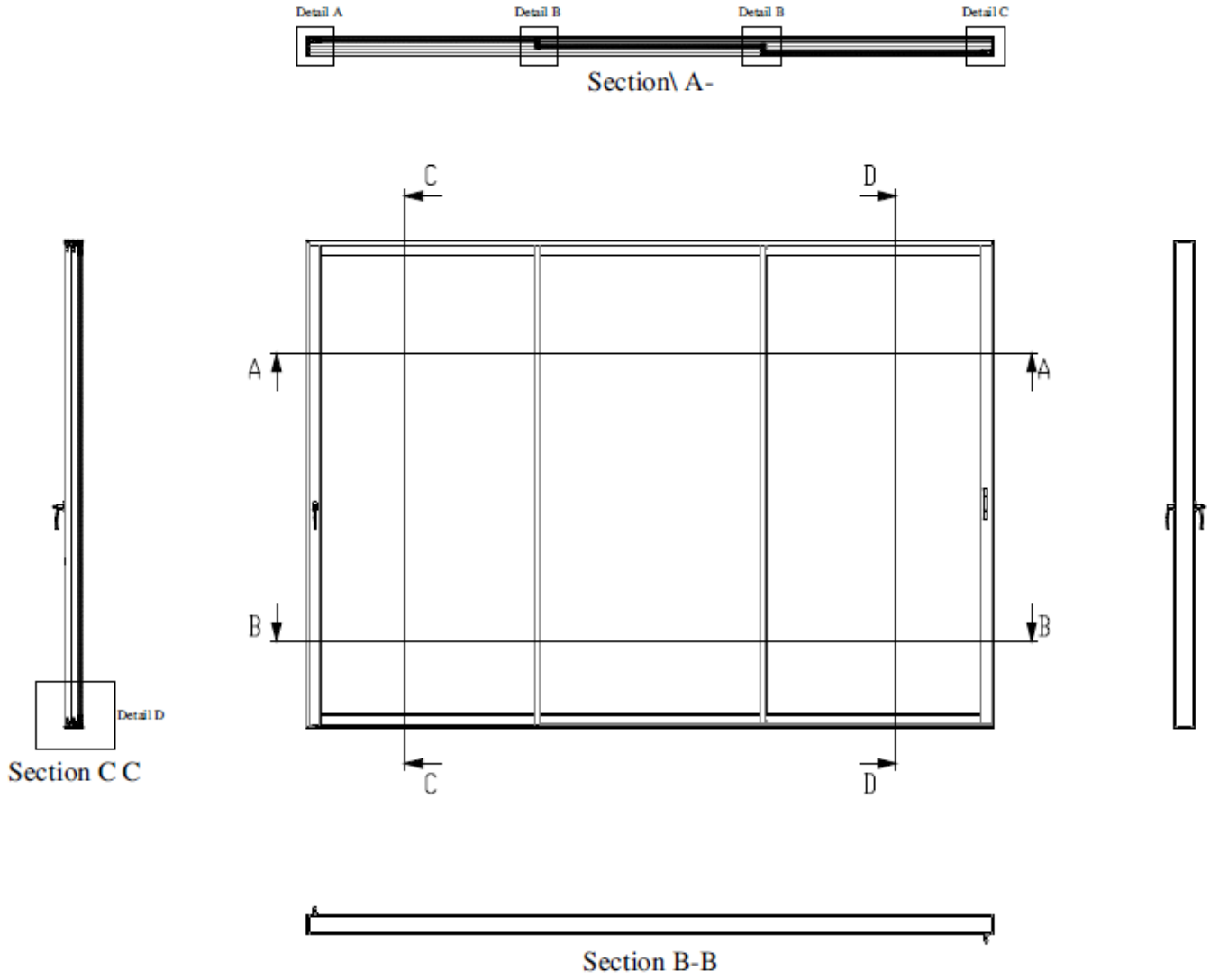

4 CHANNEL - 4 PANNELS (SINGLE SIDE)

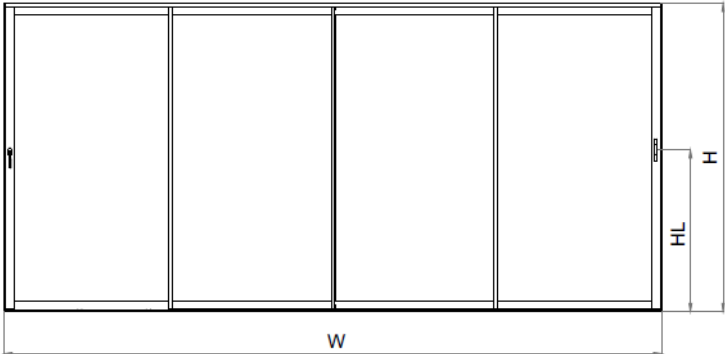

4 CHANNEL - 8 PANNELS (DOUBLE SIDE)

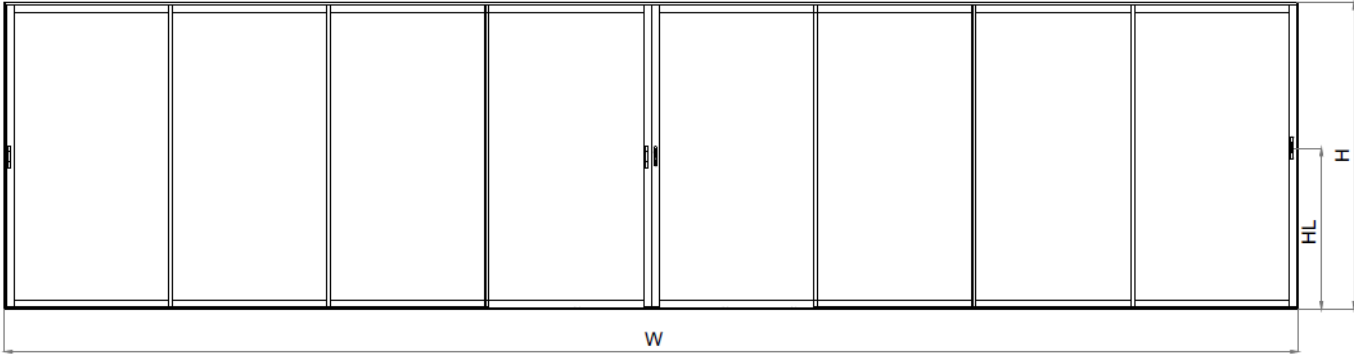

3 CHANNEL - 3 PANELS (SINGLE SIDE)

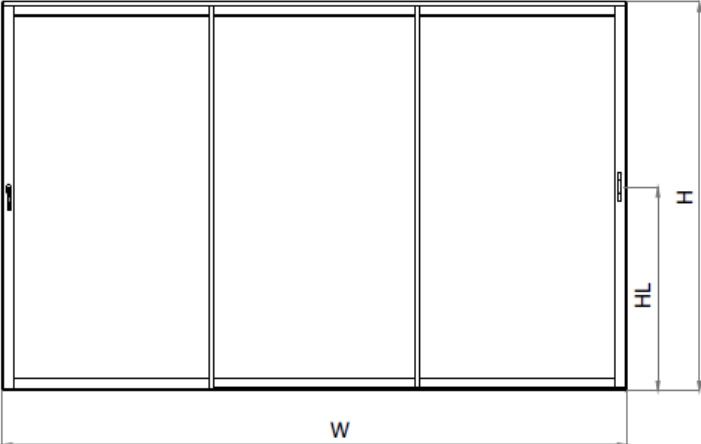

3 CHANNEL - 6 PANELS (DOUBLE SIDE)

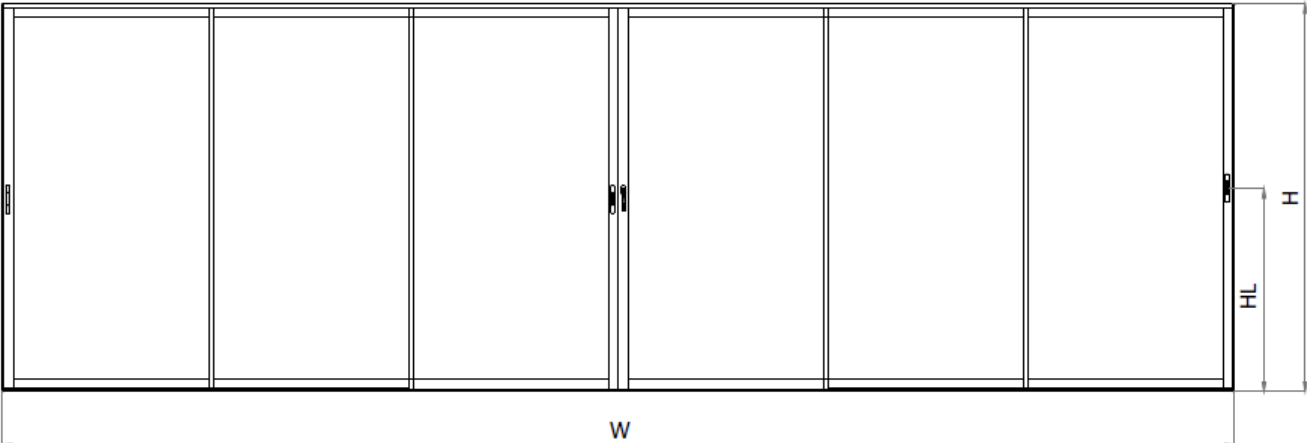

3 CHANNEL - 2 PANELS (SINGLE SIDE)

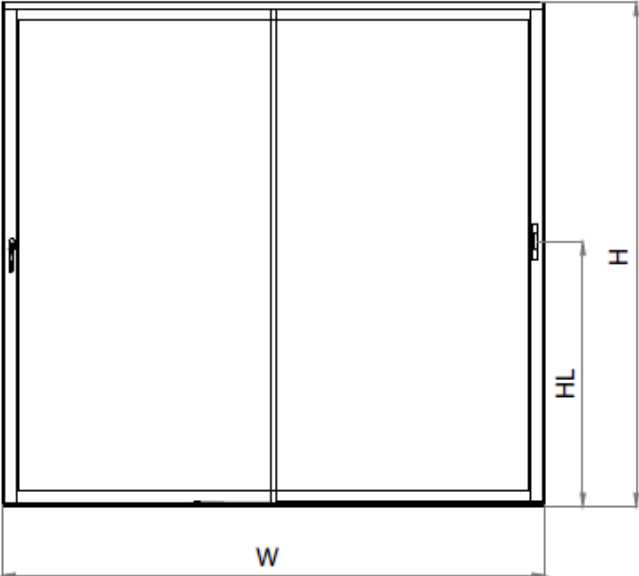

3 CHANNEL - 4 PANELS (DOUBLE SIDE)

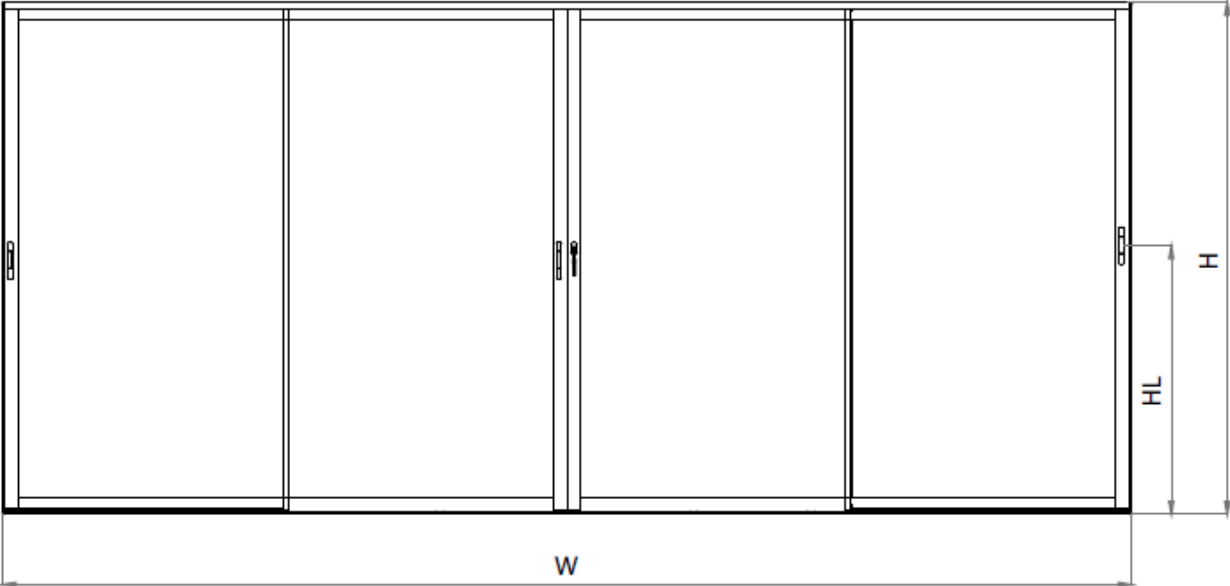

FINANCIAL OFFER
SLIDING GLASS SYSTEM

Dimensions	Price
SLIDING SYSTEM WITH FRAME 3 CHANNEL RAIL 3 PANNELS (ONE SIDE) (3.147x3m) (1 Pcs.)	
SLIDING SYSTEM WITH FRAME 3 CHANNEL RAIL 3 PANNELS (ONE SIDE) (3.277x3m) (1 Pcs.)	
SLIDING SYSTEM WITH FRAME 4 CHANNEL RAIL 4 PANNELS (ONE SIDE) (4.57x3m) (1 Pcs.)	
SLIDING SYSTEM WITH FRAME 4 CHANNEL RAIL 4 PANNELS (ONE SIDE) (3.834x3m) (1 Pcs.)	
SLIDING SYSTEM WITH FRAME 4 CHANNEL RAIL 4 PANNELS (ONE SIDE) (3.956x3m) (1 Pcs.)	
SLIDING SYSTEM WITH FRAME 3 CHANNEL RAIL 3 PANNELS (ONE SIDE) (2.735x3m) (1 Pcs.)	
SLIDING SYSTEM WITH FRAME 4 CHANNEL RAIL 4 PANNELS (ONE SIDE) (4.096x3m) (1 Pcs.)	
SLIDING SYSTEM WITH FRAME 4 CHANNEL RAIL 4 PANNELS (ONE SIDE) (4.046x3m) (1 Pcs.)	
SLIDING SYSTEM WITH FRAME 3 CHANNEL RAIL 3 PANNELS (ONE SIDE) (3.146x3m) (1 Pcs.)	
Package	
Price	
FIXED GLASS 3147X665	
FIXED GLASS 3277X665	
FIXED GLASS 4570X665	
FIXED GLASS 3834X665	
FIXED GLASS 3956X665	
FIXED GLASS 2715X817	
FIXED GLASS 4096X665	
FIXED GLASS 3992X1010	
FIXED GLASS 3092X1096	
Price without VAT	
Discount (%)	
Price	

FINANCIAL OFFER



The prices are in EURO.

Delivery date: 30 days after the advance payment.

Method of payment: 50% at confirmation of the order. 50% before shipping.

5 years warranty.